

MOUNTING DIMENSIONS, SIZE 18

SERIES 31

H(S)P-10V18

SERVICE PORTS ON SIDE; NON THROUGH DRIVE, MODELS 62N00 AND 12N00

Without Considering Adjustment

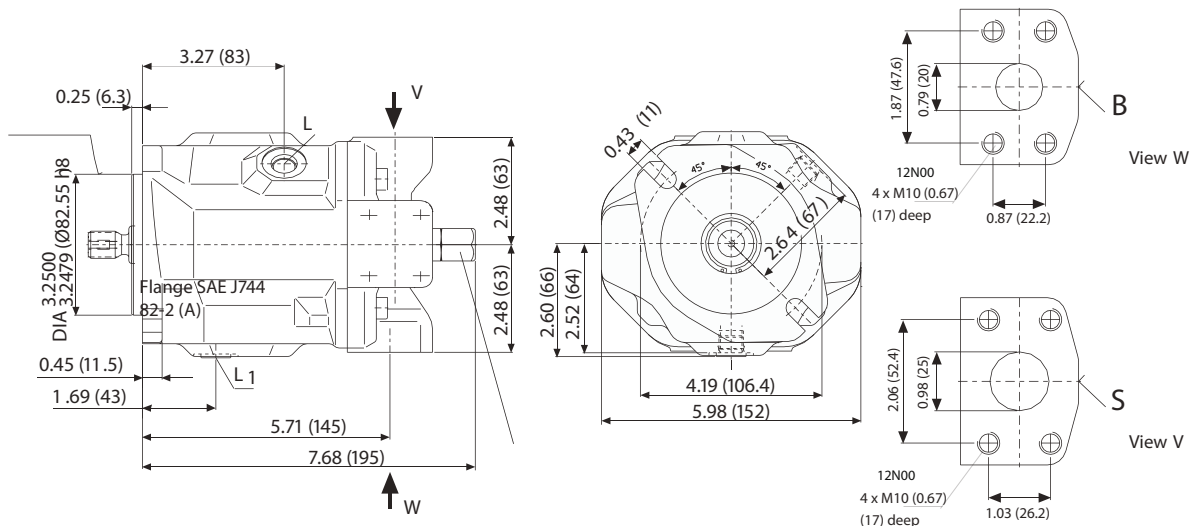

Shaft ends

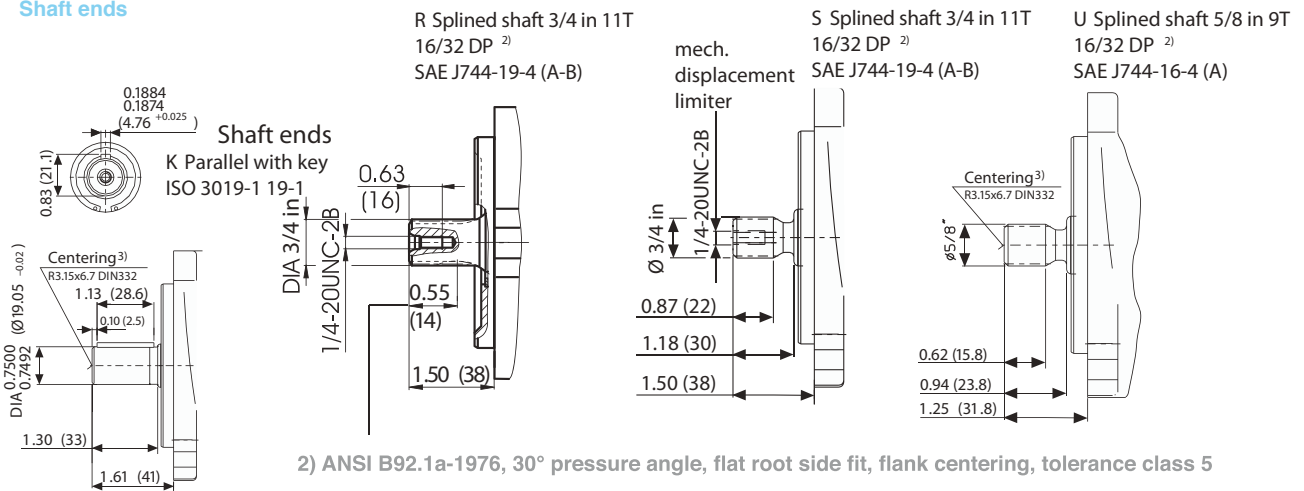

Ports

| Designation | Port for | Standard | Size | Peak Pressure [psi (bar)] | Tightening Torque Max [lb-ft (Nm)] |
|-------------------|--|--------------------|---|---------------------------|------------------------------------|
| B | Pressure port (standard pressure range) Threading in bolt holes | SAE J518 ISO 68 | 3/4 in 3/8-16 UNC-2B; 0.79 (20) deep | 5100 (350) | 29 (40) |
| S | Inlet (standard pressure range) Threading in bolt holes | SAE J518 ISO 68 | 1 in 3/8-15 UNC-2B; 0.79 (20) deep | 75 (5) | 29 (40) |
| L, L ₁ | Case drain (L ₁ plugged) | ISO 11926 | 9/16-18 UNF-2B | 30 (2) | 59 (80) |
| X | Pilot Pressure | ISO 11926 | 7/16-20 UNF-2B; 0.39 (10) deep | 5100 (350) | 29 (40) |
| X | Control pressure for DG control | DIN 3852 | R 1/4 in | 1740 (120) | 48 (70) |

1) Dependent on the installation position, port L or L₁ must be connected